

# FV-KUPPLUNG

## FV-F-T

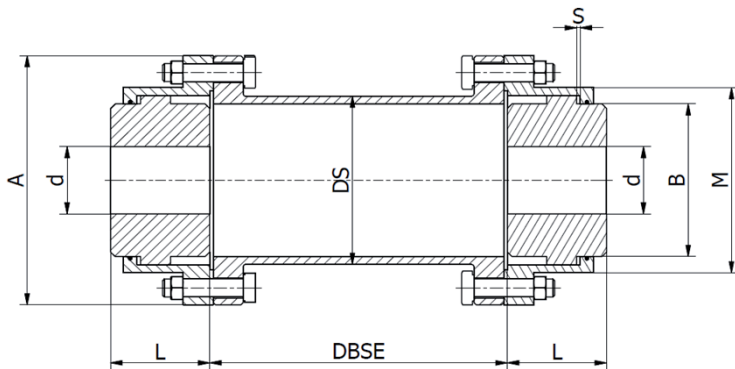

- Gear coupling with intermediate spacer
- Spacer made by welded steel tube
- Tube length up to 3m
- Spare spacer or special design are possible
- Perfect interchangeable with industrial standard manufacturers
- Angular misalignment +/- 0,4°
- Temperature range -20°C / + 80°C

### PRODUCT CODE KEY - EXAMPLE

	FV	F	203	T	100	90	450	S
Model								
Design								
Size								
Construction								
Bore D1								
Bore D2								
DBSE dimension								
Special design according text specification								

	TKN	TKMax	Speed	Ød bore	A	B	L	M	DS	DBSE	S
	kNm	KNm	Rpm-max	Max mm	mm	mm	mm	mm	mm	mm	mm
<b>F-T</b>											
<b>96</b>	1,9	4,2	3000	52	111	68	43	82,5	82,5	o.r.	1,5
<b>122</b>	2,9	6,8	2500	62	142	86	50	104,6	88,9	o.r.	1,5
<b>148</b>	5,7	14	2000	78	168	105	62	130,5	127	o.r.	1,5
<b>178</b>	9	21,5	1800	98	200	132	76	158,4	139	o.r.	2,5
<b>203</b>	14,5	35	1500	112	225	151	90	183,4	168	o.r.	2,5
<b>236</b>	22,8	54,7	1350	132	265	179	105	211,5	168	o.r.	3
<b>270</b>	34,8	83,5	1200	156	300	209	120	245,5	219	o.r.	3
<b>300</b>	45,8	110	1100	174	330	234	135	275	273	o.r.	4
<b>335</b>	70,8	170	950	190	370	255	150	307	273	o.r.	4
<b>368</b>	85,4	205	900	210	406	280	175	335	324	o.r.	4
<b>400</b>	150	360	800	233	439	306	190	367	355	o.r.	4
<b>460</b>	200	480	700	280	505	356	220	423	406	o.r.	5

TKN is calculated for 24H continuous operation and maximum 20 start-up per hour - For sizing see related page

TKMax is permitted only five times per hour

Different design and sizes are possible

**Please note:** couplings are supplied without lubricants. For lubricants see technical appendix